

GENERAL NOTES:

Do not scale off this drawing.
All dimensions to be verified on site prior to construction,
manufacture & installation of all items.
Any discrepancies to be brought to the attention of the
Design Team. All dimensions are shown in millimetres unless
stated otherwise.
Drawing indicates design intent only.

Contractor to visit the site and be knowledgeable of existing
site conditions prior to the tendering process.
Contractor shall notify the Design Team of any conditions
requiring modification or that may have an impact on the
design.

Workmanship and materials to comply with the Building
Regulations and British Standards code of practice.
All materials shall be used in accordance with the
Manufacturer's instructions and specifications. All existing
items that are to be kept/reused to be protected against
damage for the duration of the construction works.

All Joinery drawings to be read in conjunction with all
relevant drawings including Demolition, GA, Partition, Floor
& Wall Finishes Plans etc and any cross-referenced Detailed
Drawings and Schedules (for Specifications and
Manufacturer / Supplier information). Refer to Drawing Issue
Register for comprehensive drawing list.

Contractor / Joiner to ensure sulling and tolerances of all
undercounter equipment. Joinery to be constructed from
moisture resistant (MIR) substrate unless specified otherwise.
Contractor to confirm MFC substrate thicknesses to ensure
strength and stability of construction.

All full height joinery to be securely braced back to walls.
Generally, all internal and external faces and edges of
carcase in noted finishes, no visible fixings. All drawers and
doors to be soft-close. Provide suitable quantities of
heavy-duty, all metal hinges - Hafele or similar.

Contractor to provide Details / Shop Drawings to be issued
to the Design Team for approval prior to manufacture.
Ensure M&E Consultant information has been co-ordinated
and integrated into shop drawings where necessary.
Copyright CML Creative Ltd / Via Hermantes Studio.

Area: 927 sqm / 9,978 sqft
9.1sqm/pp

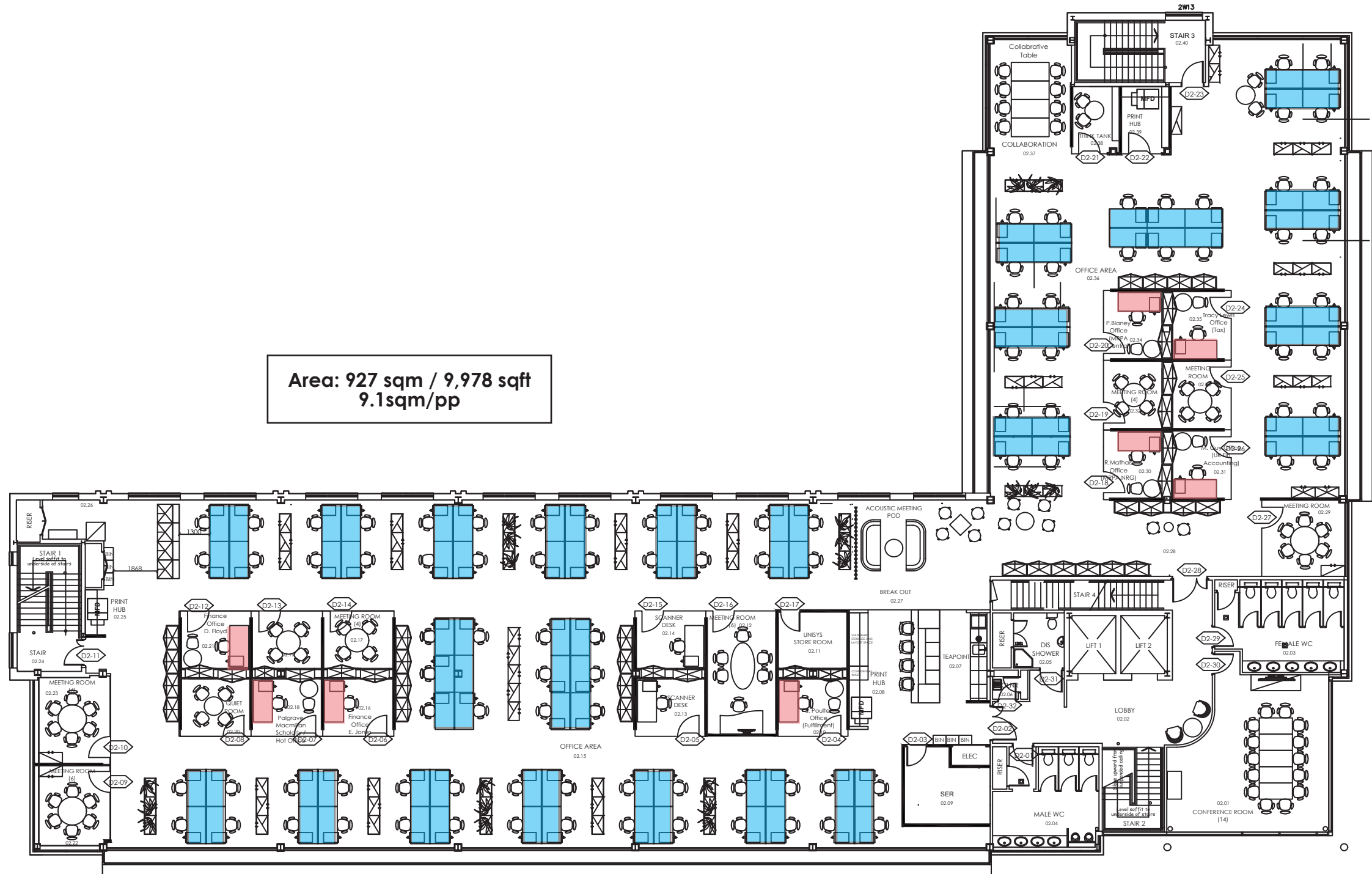

94 Desks
8 Offices

Total 102 Desks

STORAGE CAPACITY

3H x 53 Units at 800 mm = 127.2 lm

5H x 16 Units at 1000 mm = 80 lm

6H x 16 Units at 1000 mm = 96 lm

Total 303.2 lm

SECOND FLOOR EXISTING PLAN - 1600mm Desks 1:200 @A3

No.	Comment	Date	Drawn
-----	---------	------	-------

Revisions

Cost Consultant	Project Manager
-----------------	-----------------

CDM Consultant	Services Consultant
----------------	---------------------

Client

Macmillan
& Springer Nature

Project
Basingstoke Consolidation
Cromwell Place
Chineham Estate
Basingstoke

Drawing Title
SECOND FLOOR
Existing Layout

Issue Status	Rev.
-	Rev ID

Scale	Date
1:200 @ A3	18 March 2020

Project Num.	Drawing Num.	Drawn By
1015	SK.2_EX	EC

Copyright CML Creative Ltd/ Via HERMANTES STUDIO

GENERAL NOTES:

Do not scale off this drawing.
All dimensions to be verified on site prior to construction,
manufacture & installation of all items.
Any discrepancies to be brought to the attention of the
Design Team. All dimensions are shown in millimetres unless
stated otherwise.
Drawing indicates design intent only.

Contractor to visit the site and be knowledgeable of existing
site conditions prior to the Tendering Process.
Contractor shall notify the Design Team of any conditions
requiring modification or that may have an impact on the
design.

Workmanship and materials to comply with the Building
Regulations and British Standards code of practice.
All materials shall be used in accordance with the
Manufacturer's instructions and specifications. All existing
items that are to be kept/reused to be protected against
damage for the duration of the construction works.

All Joinery drawings to be read in conjunction with all
relevant drawings including Demolition, G.A. Partition, Floor
& Wall Finishes Plans etc. and any cross-referenced Detailed
Drawings and Schedules (for Specifications and
Manufacturer / Supplier information). Refer to Drawing Issue
Register for comprehensive drawing list.

Contractor / Joiner to ensure sulling and tolerances of all
undercounter equipment. Joinery to be constructed from
moisture resistant (MR) substrate unless specified otherwise.
Contractor to confirm MDF/substrate thicknesses to ensure
strength and stability of construction.

All full height joinery to be securely braced back to walls.
Generally, all internal and external faces and edges of
carcase in noted finishes. No visible fixings. All drawers and
doors to be soft-close. Provide suitable quantities of
heavy-duty, all metal hinges - Hafele or similar.

Contractor to provide Details / Shop Drawings to be issued
to the Design Team for approval prior to manufacture.
Ensure M&E Consultant information has been co-ordinated
and integrated into shop drawings where necessary.
Copyright CML Creative Ltd t/a Hermantes Studio.

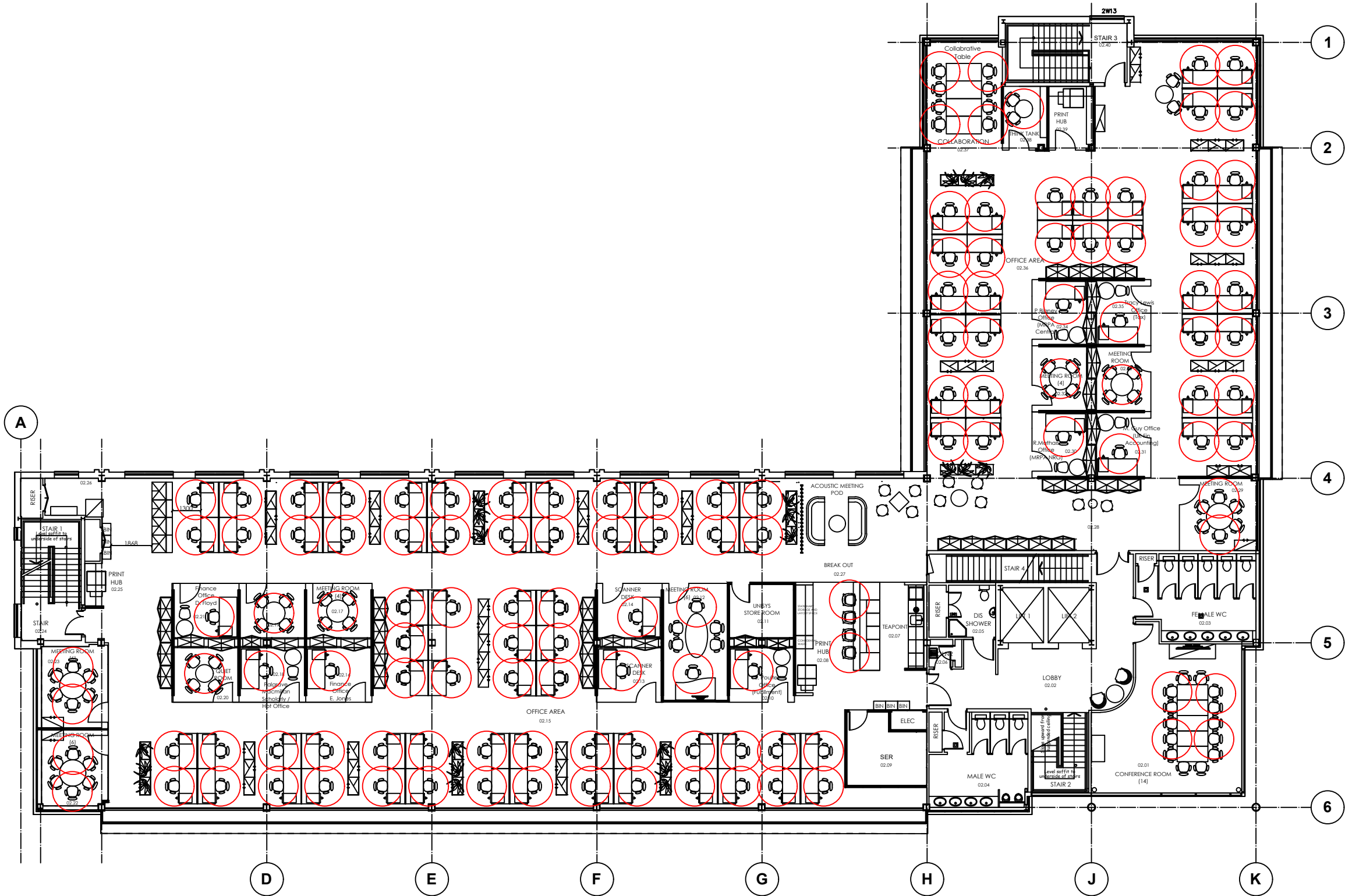

No.	Comment	Date	Drawn
-----	---------	------	-------

Revisions

Cost Consultant	Project Manager
-----------------	-----------------

CDM Consultant	Services Consultant
----------------	---------------------

Client

**Macmillan
& Springer Nature**

Project
**Basingstoke Consolidation
Cromwell Place
Chineham Estate
Basingstoke**

Drawing Title
**SECOND FLOOR
Existing Layout**

Issue Status	Rev.
-	Rev ID

Scale	Date
1:200 @ A3	23 March 2020

Project Num.	Drawing Num.	Drawn By
1015	SK.2 EX	EC

Copyright CML Creative Ltd/ t/a HERMANTES STUDIO

Do not scale off this drawing.
All dimensions to be verified on site prior to construction,
manufacture & installation of all items.
Any discrepancies to be brought to the attention of the
Design Team. All dimensions are shown in millimetres unless
stated otherwise.
Drawing Indicates design intent only.

Contractor to visit the site and be knowledgeable of existing site conditions prior to the Tendering Process. Contractor shall notify the Design Team of any conditions requiring modification or that may have an impact on the design.

Workmanship and materials to comply with the Building Regulations and British Standards code of practice. All materials shall be used in accordance with the Manufacturer's instructions and specifications. All existing items that are to be kept/reused to be protected against damage for the duration of the construction works.

All Joinery drawings to be read in conjunction with all relevant drawings including Demolition, GA, Partition, Floor & Wall Finishes Plans etc and any cross-referenced Detailed Drawings and Schedules (for Specifications and Manufacturer / Supplier information). Refer to Drawing Issue Register for comprehensive drawing list.

Contractor / Joiner to ensure suiting and tolerances of all undercounter equipment. Joinery to be constructed from moisture resistant (MR) substrate unless specified otherwise. Contractor to confirm MDF/substrate thicknesses to ensure strength and stability of construction.

All full height joinery to be securely braced back to walls. Generally, all internal and external faces and edges of carcass in noted finishes. No visible fixings. All drawers and doors to be soft-close. Provide suitable quantities of heavy-duty, all metal hinges - Hafele or similar.

Contractor to provide Details / Shop Drawings to be issued to the Design Team for approval prior to manufacture. Ensure M&E Consultant information has been co-ordinated and integrated into shop drawings where necessary.
Copyright CML Creative Ltd t/a Hermantes Studio.



No.	Comment	Date	Drawn
Revisions			
Consolidant	Project Manager		
-	-		
CDM Consultant	Services Consultant		
-	-		
Client			
Macmillan & Springer Nature			
Project			
Basingstoke Consolidation Cromwell Place Chineham Estate Basingstoke			
Drawing Title			
SECOND FLOOR Pedestal Change Layout EX.01			
Issue Status	Rev.		
-	-		
Scale	Date		
1:200 @ A3	07 May 2020		
Project Num.	Drawing Num.	Drawn By	
1015	SK.2_EX.01	EC	
Copyright CML Creative Ltd/ t/a HERMANDES STUDIO			

GENERAL NOTES:

Do not scale off this drawing.
All dimensions to be verified on site prior to construction, manufacture & installation of all items.
Any discrepancies to be brought to the attention of the Design Team. All dimensions are shown in millimetres unless stated otherwise.
Drawing indicates design intent only.

Contractor to visit the site and be knowledgeable of existing site conditions prior to the Tenders Process.
Contractor shall notify the Design Team of any conditions requiring modification or that may have an impact on the design.

Workmanship and materials to comply with the Building Regulations and British Standards code of practice.
All materials shall be used in accordance with the Manufacturer's instructions and specifications. All existing items that are to be kept/reused to be protected against damage for the duration of the construction works.

All Joinery drawings to be read in conjunction with all relevant drawings including Demolition, GA, Partition, Floor & Wall Finishes Plans etc. and any cross-referenced Detailed Drawings and Schedules (for Specifications and Manufacturer / Supplier information). Refer to Drawing Issue Register for comprehensive drawing list.

Contractor / Joiner to ensure sulling and tolerances of all undercounter equipment. Joinery to be constructed from moisture resistant (MR) substrate unless specified otherwise.
Contractor to confirm MDF (substrate) thicknesses to ensure strength and stability of construction.
All full height joinery to be securely braced back to walls.
Generally, all internal and external faces and edges of carcasses in noted finishes. No visible flairs. All drawers and doors to be soft-close. Provide suitable quantities of heavy-duty, all metal hinges - Hafele or similar.

Contractor to provide Details / Shop Drawings to be issued to the Design Team for approval prior to manufacture. Ensure H&M Consultant information has been co-ordinated and integrated into shop drawings where necessary.
Copyright CML Creative Ltd t/a Hermantes Studio.

No.	Comment	Date	Drawn
-----	---------	------	-------

Revisions

Cost Consultant	Project Manager
-----------------	-----------------

CDM Consultant	Services Consultant
----------------	---------------------

Client

**Macmillan
& Springer Nature**

Project
**Basingstoke Consolidation
Cromwell Place
Chineham Estate
Basingstoke**

Drawing Title
**SECOND FLOOR
Increased Distancing Layout
EX.02**

Issue Status	Rev.
--------------	------

Scale	Date
1:200 @ A3	07 May 2020

Project Num.	Drawing Num.	Drawn By
1015	SK.2 EX.02	EC

Copyright CML Creative Ltd/ t/a HERMANTES STUDIO

