

# 10 | WP

MEPC



WP | Wellington  
Place Leeds

**Available Now**

3,929 sq ft (365 sq m) Grade A  
Ground Floor Office Suite



# 10 Wellington Place

An impressive Grade A office building set in the heart of the vibrant Wellington Place community

10 Wellington Place is located at the heart of the Wellington Place neighbourhood. With impressive floor-to-ceiling glazing, occupiers enjoy the outlook across Tower Square's landscaped gardens and the historic Wagon Lifting Hoist.



Floor	Use	NIA sq m	NIA sq ft	Status
Ground	Office	365	3,929	Available
Ground	Retail	118	1,270	Let to Sociable Folk Café
First	Office	690	7,427	Let to Knights Solicitors
Second	Office	703	7,567	Let to Begbies Traynor
Third – Suite 1	Office	484	5,213	Let to Safferys
Third – Suite 2	Office	211	2,271	Let to Burendo
Fourth	Office	591	6,362	Let to Brewin Dolphin
Total available sq m		365		
Total available sq ft			3,929	

10 | WP Total available 3,929 sq ft (365 sq m)

### Ground Floor suite now available

State-of-the-art facilities and a dedicated on-site team ensure this stylish, Grade A office accommodation meets the needs of your business.

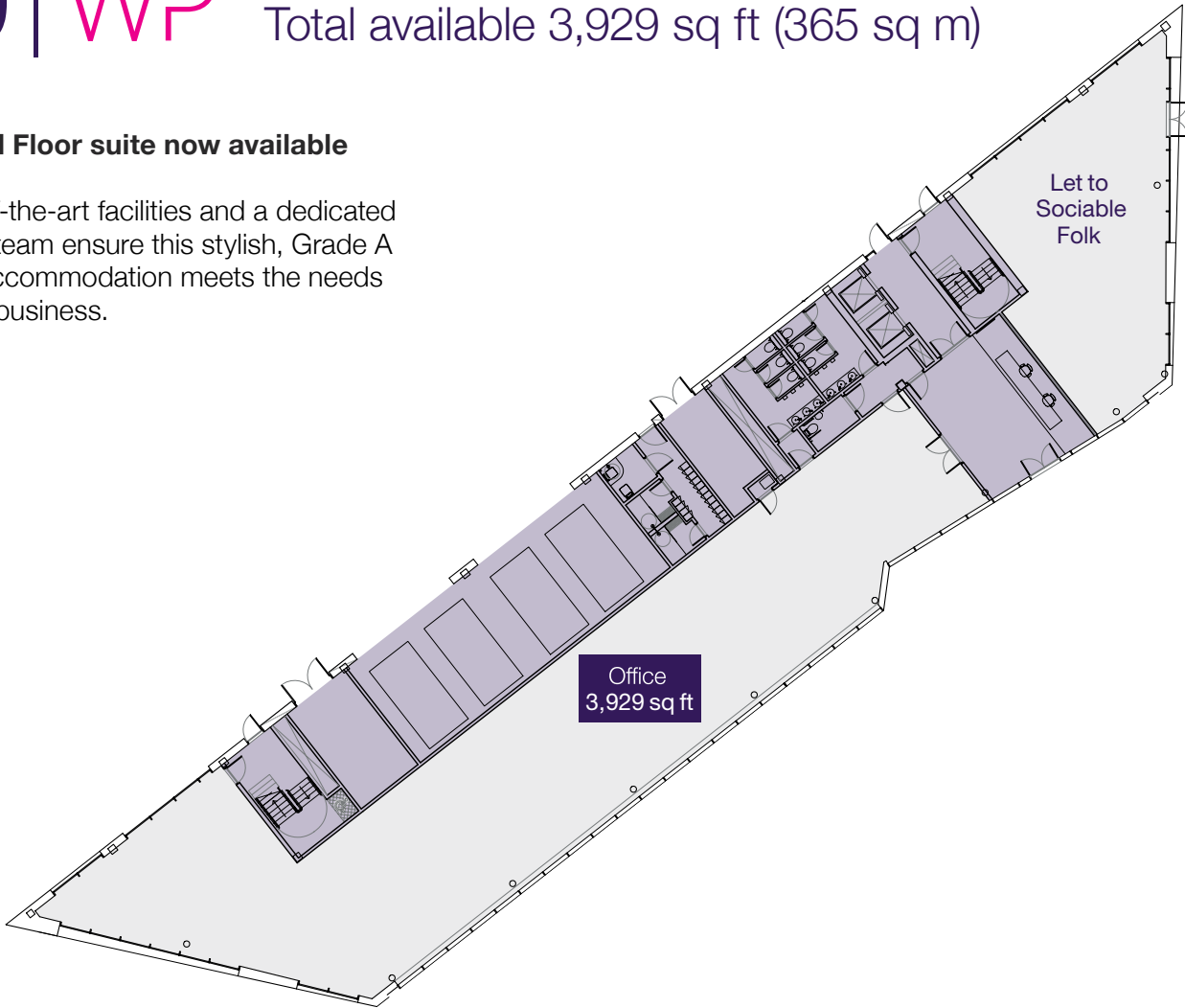

## More than just an office

### The Community

- Amenities to enhance work-life balance
- On-site cafés, restaurants, shops and bars
- 6 acres of high quality outdoor spaces & urban gardens
- Year round calendar of events
- Charitable & social impact activities to benefit the local community
- Free bike hire

### The Building

- EPC 'A' rating
- 24 hour access
- Changing facilities with showers
- Air Conditioning
- 1:10 Occupancy Rate

# Join the Wellington Place community and become part of one of the most exciting districts in Leeds.

Talk to our letting agents:



jeff.pearey@jll.com  
07738 501 673

tom.brammeld@jll.com  
07734 883 071

nick.gibby@jll.com  
07928 525 992



toby.nield@savills.com  
07796 709 814

hannah.coleman@savills.com  
07816 184 075

**Call 0113 389 9830 or visit**

**[wellingtonplace.co.uk](http://wellingtonplace.co.uk)**

**Wellington Place, Leeds LS1 4AP**



These particulars contain general information only (Particulars) to assist interested purchasers/lessees (Recipients) and may not be accurate, complete or up to date. These Particulars should not be relied upon, and no responsibility or liability is or will be accepted by the vendor/lessor or its agent(s) (or by any subsidiary or respective officer/employee) for the adequacy, accuracy or completeness of these Particulars (or of any other information, notice or document supplied or made available to Recipients).



CPP  
INVESTMENT  
BOARD

**Federated  
Hermes**

