



## Location

The site is prominently situated on the Airport Industrial Estate on the north side of Norwich, adjacent to The Aviation Academy and the operational area of Norwich Airport, and in walking distance of the terminal with improved links now planned. The Airport handles approximately 500,000 passengers annually and is a hub for the southern North Sea offshore industries in the oil, gas & windfarm energy sectors. The Airport and the Industrial Estate have been made very accessible in the Norwich area by the opening of Broadland Northway (Norther Distributor Road).

The property is on one of the Norwich's largest established business estates with nearby occupiers including KLM, Lotus, Norse, Booker and Anglian Windows. The site has three road frontages, the others being to Liberator Road Anson Road.

## Description

The site extends to 1.59 acres (0.64 ha) and is roughly square in shape and reasonably level. It has been cleared for development. There are a number of trees around the perimeter and the road boundaries have palisade fencing with electric gates to Spitfire Road and Anson Road.

## Planning & Uses

The site has full planning permission for a 126 room hotel, with 90 parking spaces. The planning permission is implemented and CIL paid (with no green levy applicable).

The site is in an area zoned for employment uses and is considered suitable for a wide variety of other commercial uses, subject to planning consent.

## Services

Mains electricity, water and drainage are understood to be connected to the property or available. Interested parties are encouraged to make enquiries as to whether these are sufficient for their requirements.

## Tenure & Terms

The site represents an extremely rare opportunity to acquire **FREEHOLD** land on the Airport Industrial Estate.

## Price

On application.



# NORWICH | SPITFIRE ROAD AIRPORT INDUSTRIAL ESTATE, NR6 6EB FREEHOLD DEVELOPMENT / STORAGE SITE FOR SALE | TO LET

## Letting

The site is available to let, as a whole or in part. On a short-term basis, it is suitable for open storage, parking and occupation with temporary buildings, subject to planning. Guide rent - from **£50,000 pa** in current condition.

On a long term basis, bespoke premises can be developed to suit the needs of a tenant on a pre-let basis.

## Viewings & Further Information

**James Allen**  
**Roche Chartered Surveyors**  
01603 756332 / 07778 297298  
jamesa@rochechs.co.uk

**Philip Johnston**  
**Guildprop**  
07870 555744 / 07870 555744  
pj@guildprop.com

## Legal Costs

Each party is to be responsible for their own legal costs incurred in the transaction.

## Please Note

The buildings shown on the site plan and site image (lined red) have now been demolished.

**Ben Common**  
**Roche Chartered Surveyors**  
01603 756340 / 07917 762230  
benc@rochechs.co.uk

**Richard Davis**  
**Guildprop**  
07818 096559 / 07818 096559  
rd@guildprop.com

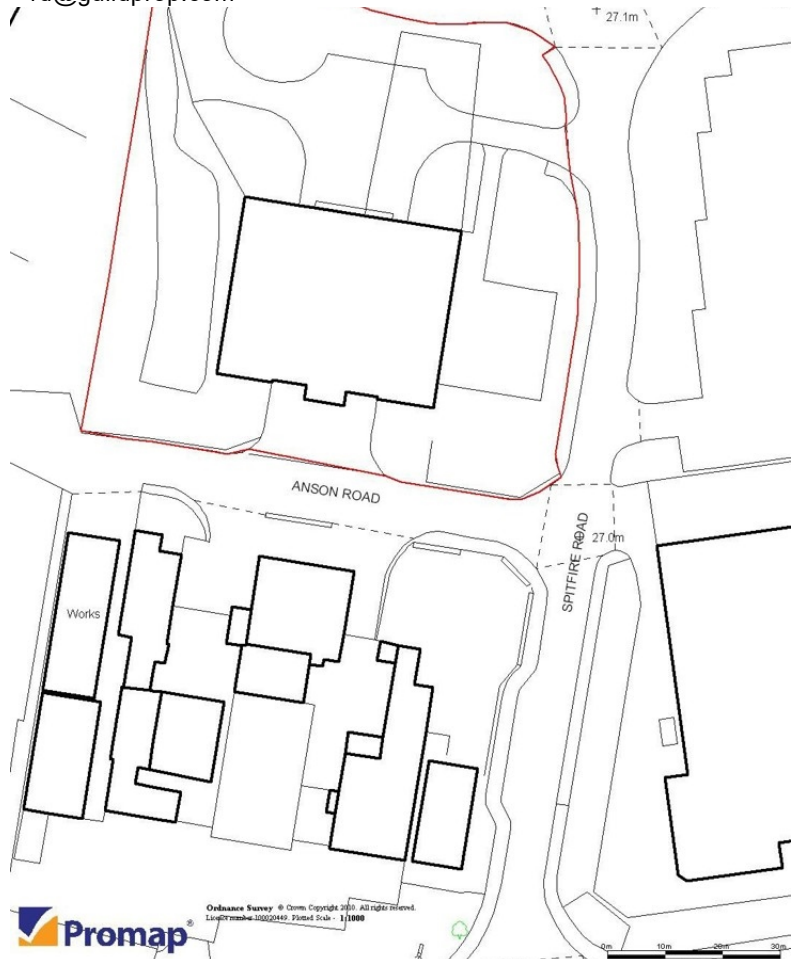



ROCHE

NORWICH | SPITFIRE ROAD  
AIRPORT INDUSTRIAL ESTATE, NR6 6EB  
FREEHOLD DEVELOPMENT / STORAGE SITE

FOR SALE | TO LET



**IMPORTANT NOTICE**

Roche Chartered Surveyors for themselves and for the Vendors or Lessors of this property, whose agents they are, give notice that:

- a) The particulars are set out as a general outline only for the guidance of intending purchasers or tenants and do not constitute, nor constitute a part of, an offer or a contract.
- b) All descriptions, dimensions, reference to condition and necessary permissions for use and occupation, and other details are given without responsibility and any intending purchasers or tenants should not rely on them as statements or representations of fact but must satisfy themselves by inspection or otherwise as to the correctness of each of them.
- c) No person in the employment of Roche Chartered Surveyors has any authority to make or give any representation or warranty whatever in relation to this property