

# Brooklyn Garage E-Class Unit

Romsey Road, Southampton, SO16 0XJ

Commercial Unit To Let



Adjacent unit pre-let to Co-op



savills



### LOCATION

The subject site is located on Romsey Road, Southampton, with direct access to the A3057. The site is approximately 6 kilometres (3.7 miles) northwest of Southampton city centre and 8 kilometres (5 miles) southeast of Romsey. Junction 3 of the M27 motorway is a short distance away, providing connections to Portsmouth (35 kilometres east) and Bournemouth (45 kilometres west). The M3 motorway offers access to London and other regional destinations.

Public transport includes regular bus services along Romsey Road and Redbridge Railway Station, approximately 2 kilometres (1.2 miles) south, with direct train services to Southampton and Salisbury. The surrounding area consists of residential neighbourhoods, retail outlets, and commercial premises, supporting local business activity.

### DESCRIPTION

A brand new E-Class unit extending to approximately 2,500 sq ft (232 sq m GIA), all set on a single floor, is available to let as part of a high-quality mixed-use development. The unit will be delivered in shell and core condition, providing incoming occupiers with the flexibility to carry out a bespoke internal fit-out to suit their specific requirements. Suitable for a variety of uses within Use Class E, the unit offers an excellent opportunity for operators seeking a well-positioned and adaptable space. The occupier will also benefit from being adjacent to a brand new Co-operative Convenience Store which will drive significant footfall to the site. Completion of the build is targeted for Q4 2026.

### ACCOMMODATION

Unit	Sq. ft	Sq. m
E-Class unit	2,500	232
Retail unit*	4,036	375
Total GIA	6,536	607

\*already let to Co-op

### KEY HIGHLIGHTS

- Proposed New ‘Class E’ Unit To Let
- 2,500 sq. ft (232 sq. m)
- Adjacent unit prelet to Co-op
- Delivered in shell & core condition
- Rental offers invited

LOCATION MAP

STREET VIEW

WHAT3WORDS

360 PANORAMIC

360 DRONE VIDEO

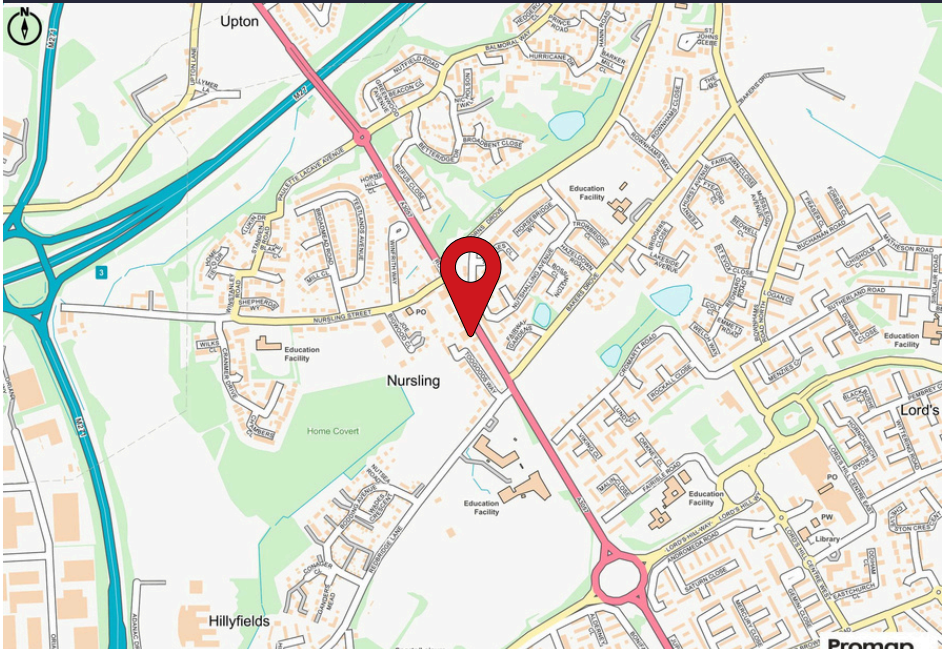

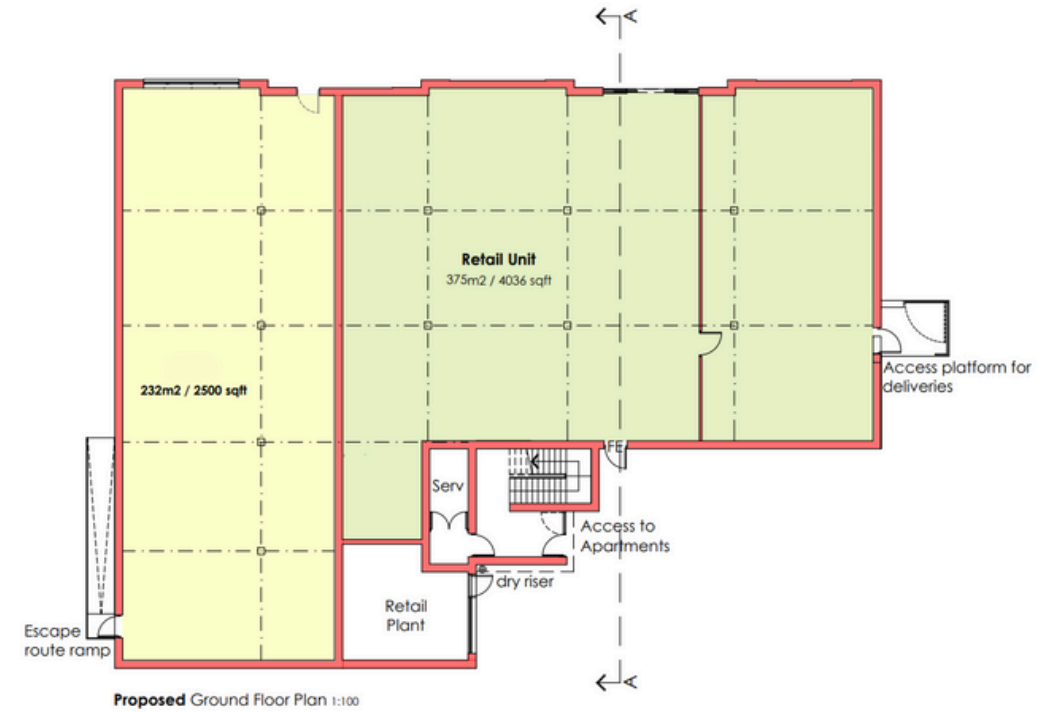





## IMPORTANT NOTICE

Savills, their clients and any joint agents give notice that:

1. They are not authorised to make or give any representations or warranties in relation to the property either here or elsewhere, either on their own behalf or on behalf of their client or otherwise. They assume no responsibility for any statement that may be made in these particulars. These particulars do not form part of any offer or contract and must not be relied upon as statements or representations of fact.
2. Any areas, measurements or distances are approximate. The text, images and plans are for guidance only and are not necessarily comprehensive. It should not be assumed that the property has all necessary planning, building regulation or other consents and Savills have not tested any services, equipment or facilities. Purchasers must satisfy themselves by inspection or otherwise.

Maps are reproduced from the Ordnance Survey Map with the permission of the Controller of H.M. Stationery Office. © Crown copyright licence number 100022432 Savills (UK) Ltd, and published for the purposes of identification only and although believed to be correct accuracy is not guaranteed.

Designed and produced by Savills Marketing: 020 7499 8644 | May 2025

## PLANNING

Planning is expected to be granted shortly under reference 24/00693/OUTS for the demolition of existing buildings and the erection of a mixed-use development, comprising of a ground floor convenience store, and additional E class unit also at ground and five flats above, with five flats, with associated access and parking.

## GUIDE PRICE

Rent on application.

## RATING

The rateable value will be assessed after completion of the unit.

## EPC

The EPC will be assessed after completion of the unit.

## VIEWING

For a formal viewing strictly by appointment with Savills.

## AML

In accordance with anti-money laundering regulations, the successful purchaser will be required to provide identification documents upon request and without delay.

## CONTACT

For further information please contact:

**Adam Bullas**  
+44 (0) 7812 965395  
abullas@savills.com

**Harry Heffer**  
+44 (0) 7929 085103  
Harry.heffer@savills.com

